

GREEN LASER MODULE

Model : GLM-532(XXX)TR-4S

Dimensions :

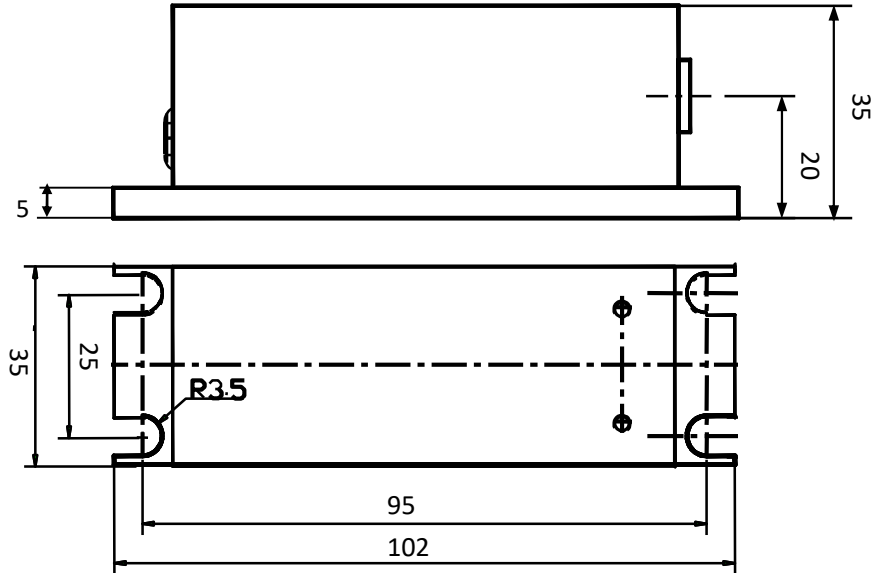

Specifications:

Wavelength	532nm	
CW Output power (APC)	50mW	100mW
e.g Output power 50mW	GLM-532(50)TR-4S	
Operating temperature	0~40°C	
Storage temperature	-20~+80°C	
Output stability (rms)	±3% over 2 hours	
beam mode	TEM ₀₀	
Beam Divergence (1/e ² , Full Angle)	< 1.0mrad	
Beam Diameter (1/e ²)	< 1.0mm	
Ellipticity	> 90%	
Residual IR	< 0.01%	
Warm up time	≤ 5minutes	
Expected lifetime	> 5,000hours	
Dimensions:	Laser Header	102X35X35mm
	Laser Driver	105X72X30mm (Mode : DD-R2000)
Power supply	12VDC (OEM)	



RAISE ELECTRO-OPTICS CO., LTD.
 13F., No. 367, Fude 3rd Rd., Xizhi Dist.,
 New Taipei City 221011, Taiwan (R.O.C.)

TEL: 886-2-2788 4817
 FAX: 886-2-2788 7809
 Http: www.raise.com.tw
 E-mail: raise.laser@msa.hinet.net